



London SE3
£1,850

jdm
LETTINGS

Description:

This 3 bedroom end of terrace 'Span' house, is very well positioned in the centre of the private Cator Estate in The Plantation, off Morden Road, and is regarded as one of the most desirable developments designed by Eric Lyons in the sixties.

There is useful porch for storing coats etc, a good size open plan living space and separate study. The kitchen is open plan to the rear of the living space. To the first floor are three bedrooms and a large modern fitted bathroom with separate shower and bath. A paved private walled garden is found to the rear of the house.

Blackheath village and the open heath are both within a short pleasant walk, the village with its interesting variety of designer shops, restaurants and pubs, together with the mainline railway station providing speedy access into central London. Offered for rent unfurnished and available from Saturday 5 December. Properties in this development are always in high demand so we would urge an early viewing.



Directions:

Tenure: Leasehold

Council Tax Band: E -£1,559.45

Local Authority: Royal Borough of Greenwich



Room Dimensions:

Porch	
Lounge	22'7" x 11'8"
Kitchen	8'5" x 6'2"
Study	9'4" x 8'5"
Bedroom 1	12'2" x 9'7"
Bedroom 2	9'11" x 9'2"
Bedroom 3	8'9" x 7' 11"
Bathroom	
Garden	24'8" x 20'1"



Please refer to www.jdmestateagents.com to see our full Area Guides.



Please contact the branch for a complete copy of the EPC document

The Plantation

APPROX. GROSS INTERNAL FLOOR AREA 984.63 SQFT / 91.47 SQM.

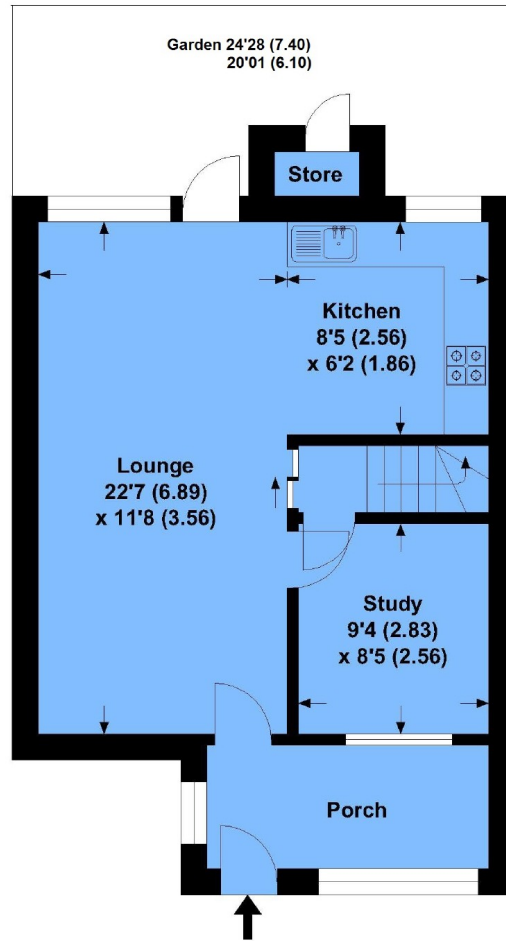

GROUND FLOOR

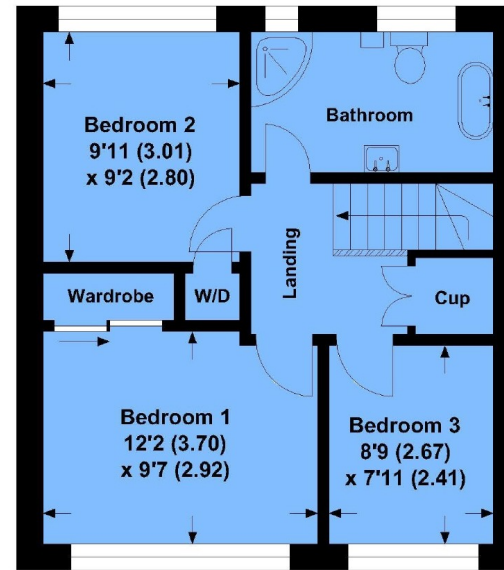

FIRST FLOOR



This is for guidance only, not to scale and must not be relied upon as a statement of fact.
Attention is drawn to the notice on these particulars.

IMPORTANT NOTICE

jdm must advise that although every effort has been made to ensure the accuracy of these details they form no part of any contract and are issued without any responsibility on the part of the agents or vendor. Photographs may have been taken using a wide angle lens. Any floor plans shown are not to scale. All measurements, walls, doors, windows, fittings and appliances, their sizes and locations are shown conventionally and are approximate only. Any reference to alterations or particular use of the property wherever stated, is not a statement that planning, building regulations or other relevant consent has been obtained. We have not carried out a survey of the property nor have we tested any services, systems or appliances at this property. We strongly recommend that all the information we provide is verified by yourselves on inspection and by your Surveyor and Solicitor or Legal Adviser.

jdm recommends Independent Mortgage Advice. For help with your mortgage please contact your local branch. Your home may be repossessed if you do not keep up repayments on your mortgage. Written quotations available on request.

jdm Blackheath Village

36 Montpelier Vale, Blackheath, London SE3 0TA

020 8463 0091 e bh@jdmonline.com



jdm
LETTINGS