

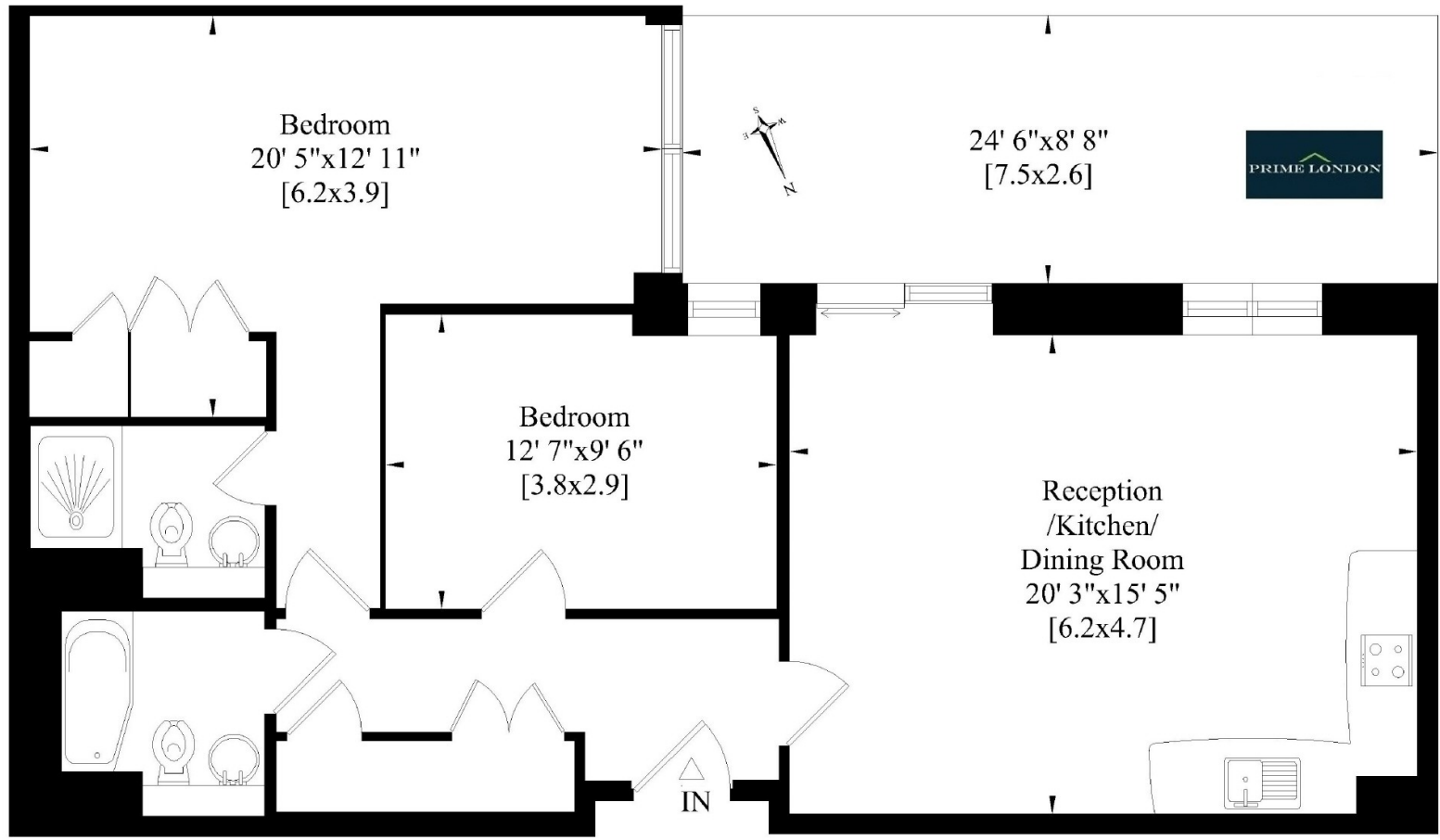

THE PERSPECTIVE BUILDING, WATERLOO
£845,000



THE PERSPECTIVE BUILDING, 100 WESTMINSTER BRIDGE ROAD, LONDON SE1
SECOND FLOOR
APPROXIMATE GROSS INTERNAL AREA 889 SQ FT / 83 SQM
APPROXIMATE GROSS EXTERNAL AREA 220 SQ FT / 20 SQM



Whilst every attempt has been made to ensure the accuracy of this floor plan, measurements of doors, windows and rooms are approximate. For identification purposes only. Not to scale.