

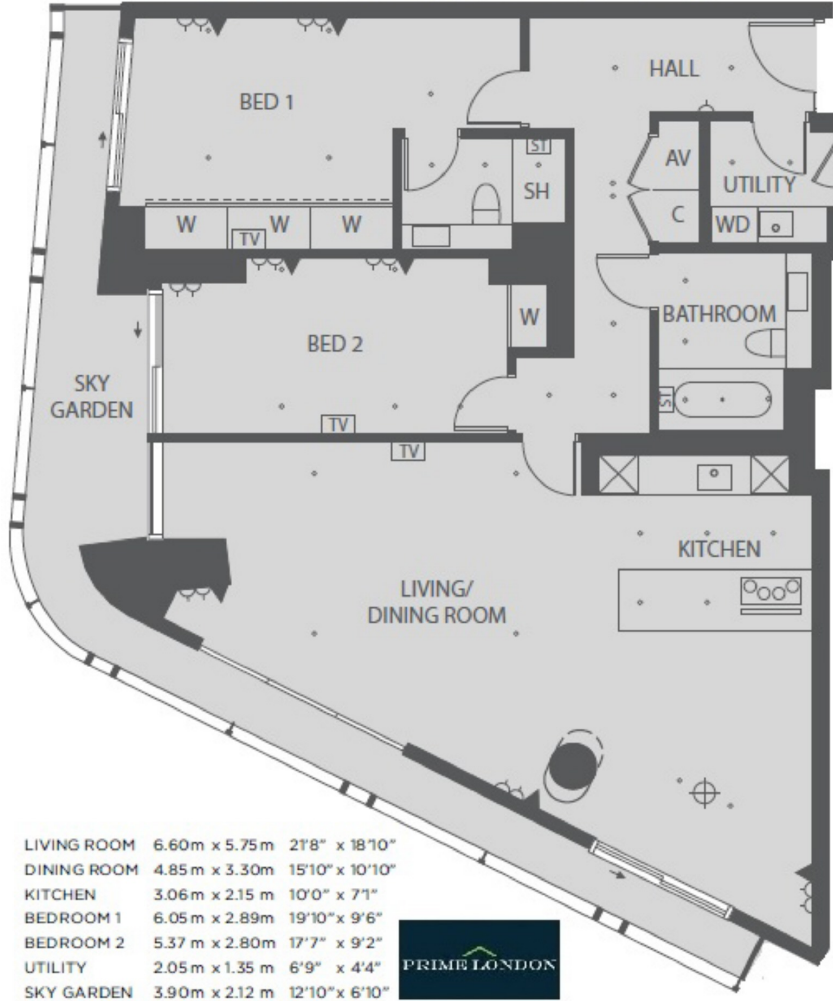

**ONE BLACKFRIARS, BANKSIDE**  
**£2,650,000**



**THE HEPWORTH COLLECTION, ONE BLACKFRIARS, SE1**  
**THIRTY-FIFTH FLOOR**  
 APPROXIMATE GROSS AREA 1,485 SQ FT / 138 SQM



LIVING ROOM	6.60m x 5.75m	21'8" x 18'10"
DINING ROOM	4.85m x 3.30m	15'10" x 10'10"
KITCHEN	3.06m x 2.15m	10'0" x 7'1"
BEDROOM 1	6.05m x 2.89m	19'10" x 9'6"
BEDROOM 2	5.37m x 2.80m	17'7" x 9'2"
UTILITY	2.05m x 1.35m	6'9" x 4'4"
SKY GARDEN	3.90m x 2.12m	12'10" x 6'10"

