

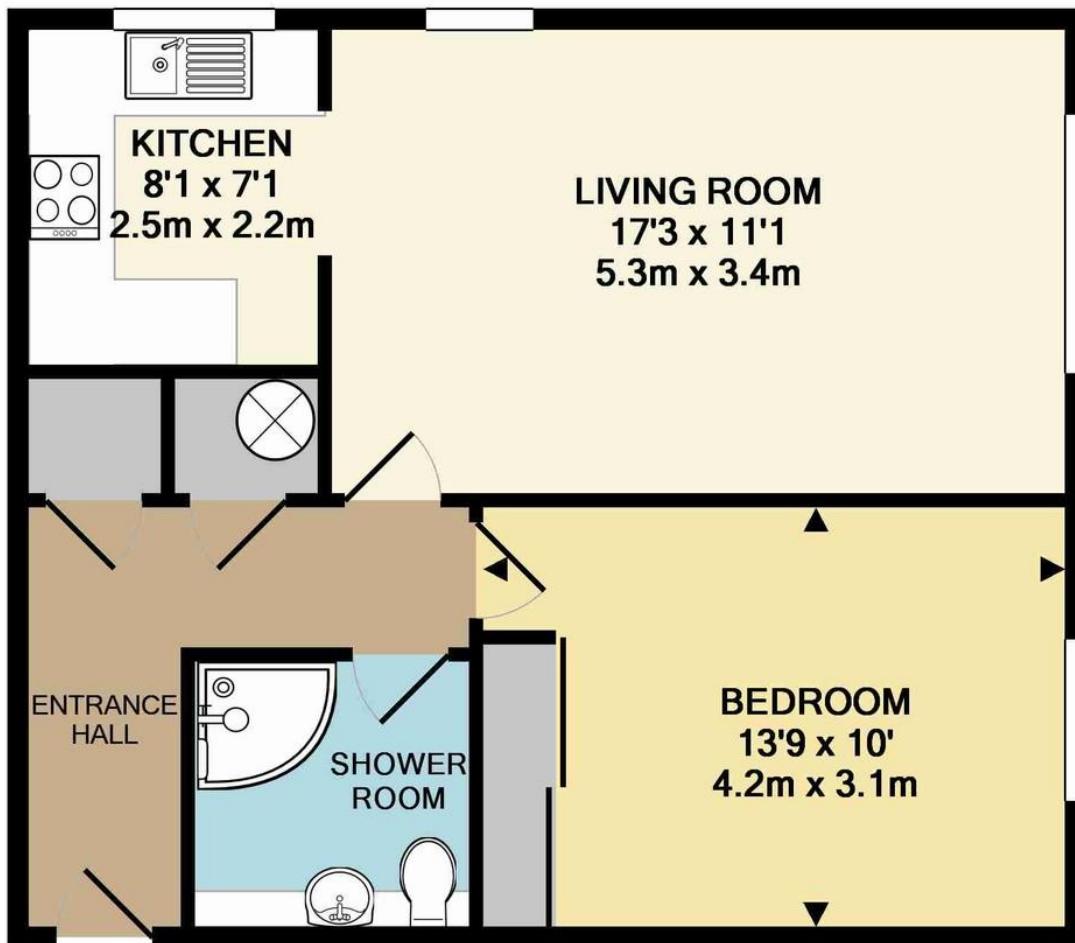

Farnborough Common | Locksbottom | BR6 8NE

£ 247,000

Chain Free. Second floor retirement flat conveniently situated for bus routes, local shops, including Sainsburys, and the PRU Hospital. This is a popular development given that there are very few opportunities to acquire retirement accommodation in this vicinity. An entryphone system provides access to a communal hall leading to lifts and stairs. The property comprises entrance hall with two good sized storage cupboards. There is a shower room with corner shower cubicle, WC and vanity sink unit. The well proportioned living room is dual aspect and leads to the kitchen which is fitted with white base and wall units, single oven, ceramic hob and there is space for a washing machine and fridge/freezer. The double bedroom has a wardrobe with sliding doors. There is a communal lounge and laundry room for the residents use and an onsite warden/manager. We are informed that residents must be aged 65 years or over and will be required to attend a medical interview.



TOTAL APPROX. FLOOR AREA 513 SQ.FT. (47.6 SQ.M.)

Whilst every attempt has been made to ensure the accuracy of the floor plan contained here, measurements of doors, windows, rooms and any other items are approximate and no responsibility is taken for any error, omission, or mis-statement. This plan is for illustrative purposes only and should be used as such by any prospective purchaser. The services, systems and appliances shown have not been tested and no guarantee as to their operability or efficiency can be given
 Made with Metropix ©2016

Contact Details

Alexandre House
 399 Crofton Road
 Orpington
 Kent
 BR6 8NL

www.jdmestateagents.com

locks@jdmestateagents.com

01689 880440

Please refer to our website to see our full Area Guides.

%epcGraph_c_1_349%

IMPORTANT NOTICE: Every effort has been made to ensure the accuracy of these details however they form no part of any contract and are issued without responsibility on the part of the agents or vendor. Any intending purchaser should satisfy themselves by inspection, searches, enquiries and survey as to the correctness of each statement. We have not carried out a survey of the property or tested services, systems or appliances. Reference to alterations or use of the property is not a statement that planning, building or other consent has been obtained. Photographs may show only certain parts and aspects of the property at the time when the photographs were taken. We recommend that all information provided is verified by yourselves on inspection and by your Surveyor/Legal Adviser.

